

Important Safety Instructions



Please carefully read and keep these instructions for future reference. If this product is passed to a third party, make sure to include these instructions.

When using the product, always follow basic safety precautions to minimize the risk of injury. **Take note of the following:**

! CAUTION Risk of injury!

- ▶ The product can tip over. Do not let children climb on or play with the product.
- ▶ This product is intended for domestic use only.
- ▶ Two competent adults should assemble this product.
- ▶ Keep children and pets away while assembling the product.
- ▶ Do not allow children to climb on or play with the product.
- ▶ Always use the product on a firm, level floor.
- ▶ Regularly check that all components and fasteners (hardware) are securely in place.
- ▶ Do not use this product if any parts are missing, damaged, or worn.
- ▶ To prevent scratches on the floor and product surface, assemble it on a soft surface like a carpet.
- ▶ Avoid overtightening the fasteners (hardware).
- ▶ Regularly inspect the product for signs of wear and tear. Replace it at the first indication of damage or if parts become detached.
- ▶ Do not sit or stand on the product.
- ▶ Do not place hot or cold items directly on the product. Use a suitable table mat or coasters. Heat can cause chemical changes that may result in spots on the furniture finish.
- ▶ Do not push or drag the product. It requires two people to carry it when moving.

Before First Use

! DANGER Risk of suffocation!

- ▶ Keep any packaging materials away from children and pets — these materials are a potential source of danger, e.g. suffocation.
- ▶ Check the product for transport damages.
- ▶ Remove all the packing materials.
- ▶ Verify that all components and fasteners (hardware) are present and complete.

Parts List

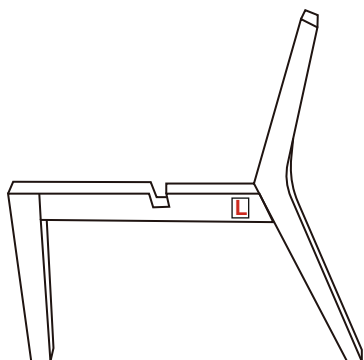

1

Left Leg

x 1pc

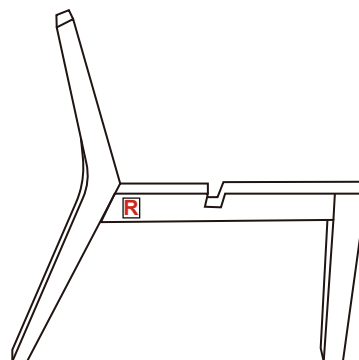

2

Right Leg

x 1pc



3

Back

x 1pc

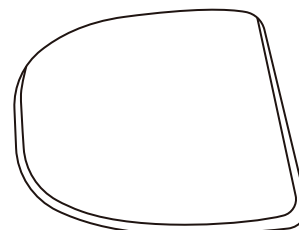

4

Surface

x 1pc

Hardware List



A

1.57inch

Used for installing the chair surface

x 4pc



B

x 6pc



C

1.37inch

Used for installing the chair back

x 2pc

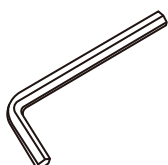

D

x 1pc



E

x 1pc



F

x 4pc



G

x 4pc

Tool Request:

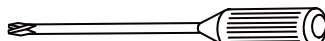

Note:List of single chair accessories

Installation steps

Step 1

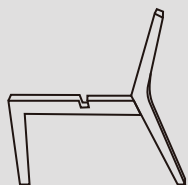

1 (x 1)

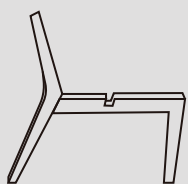

2 (x 1)

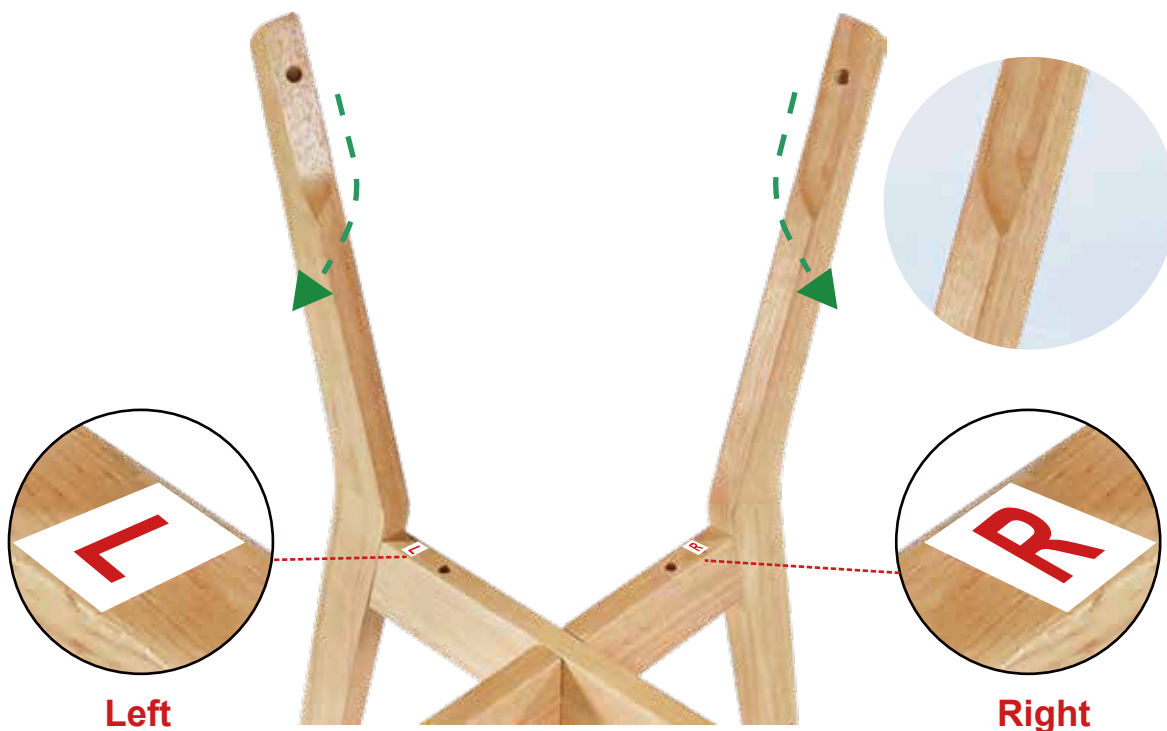

Begin the installation by crossing the left leg over and positioning it higher than the right leg.

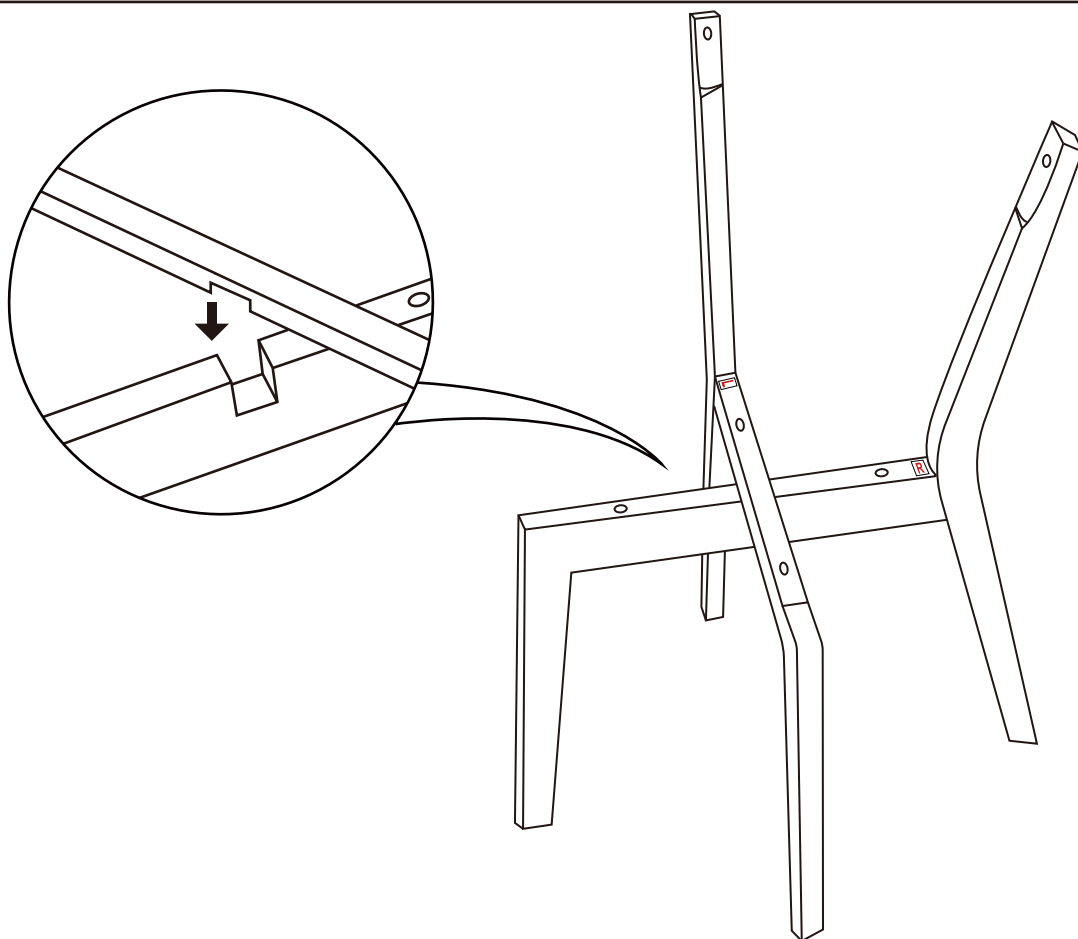

Step 2



3 (x 1)



C (x 2)



B (x 2)



D (x 1)

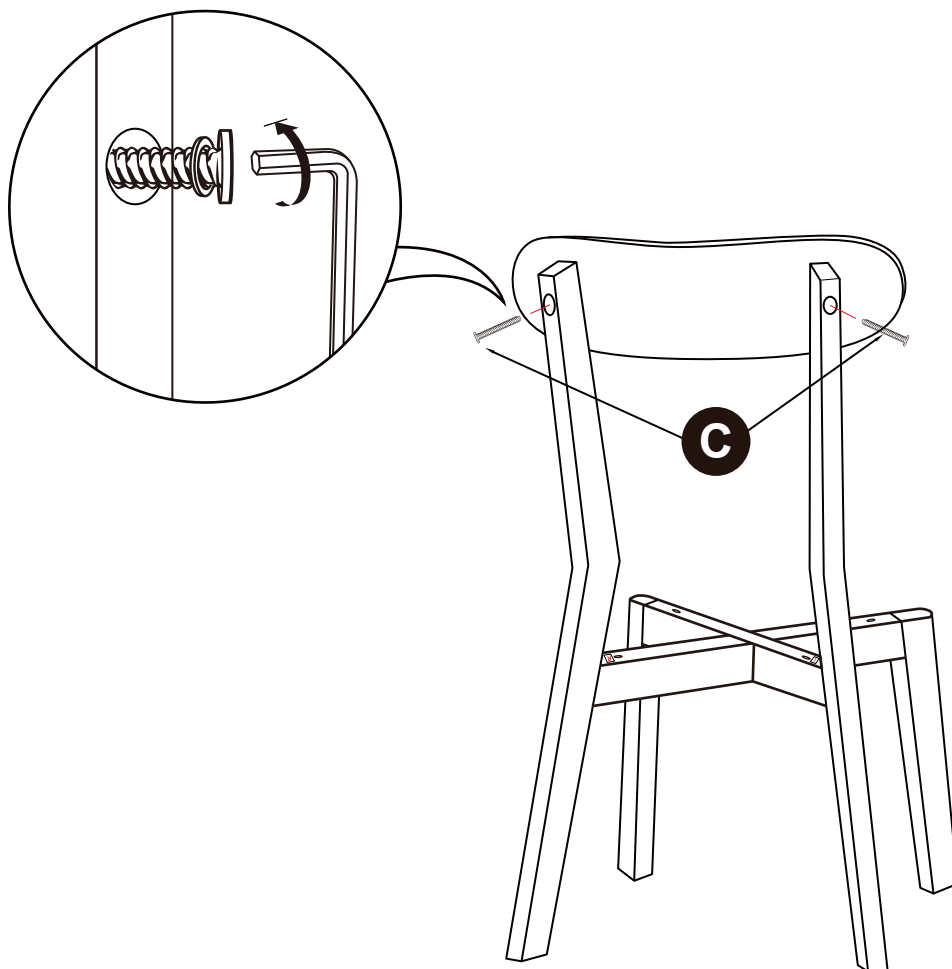
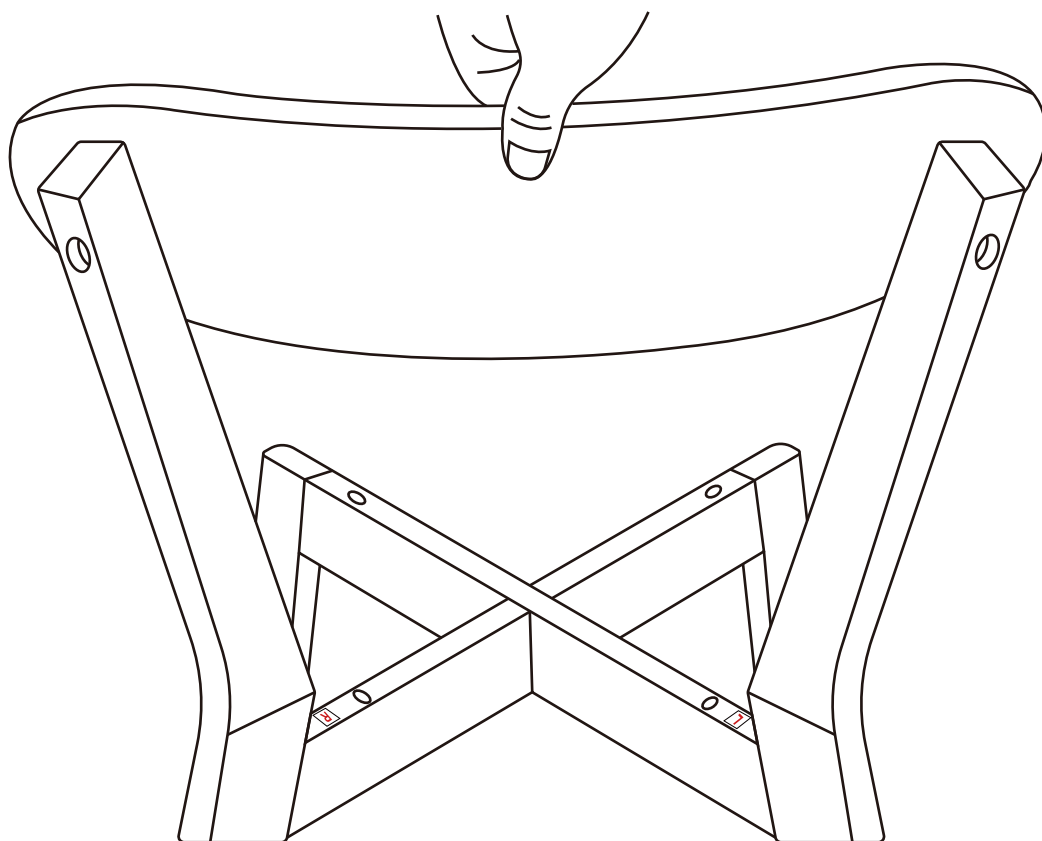

Step 3



4 (x 1)



A (x 4)



B (x 4)

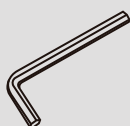

D (x 1)

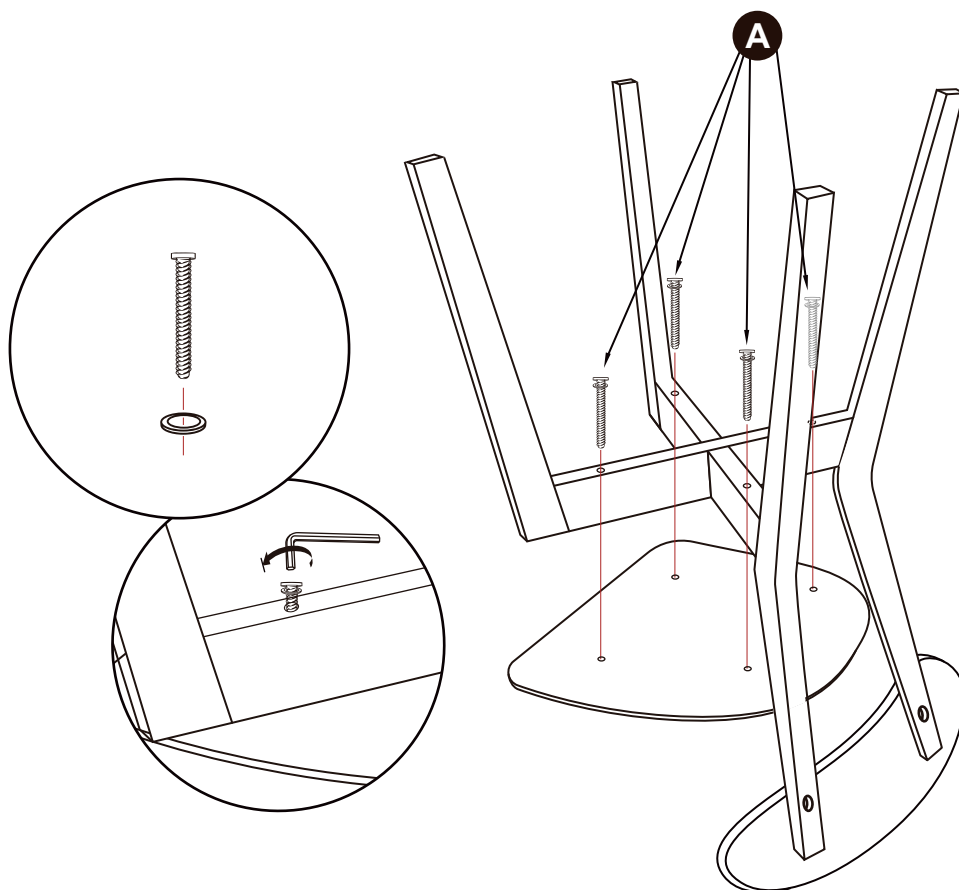

Step 4



E (x 1)



F (x 4)



G (x 4)

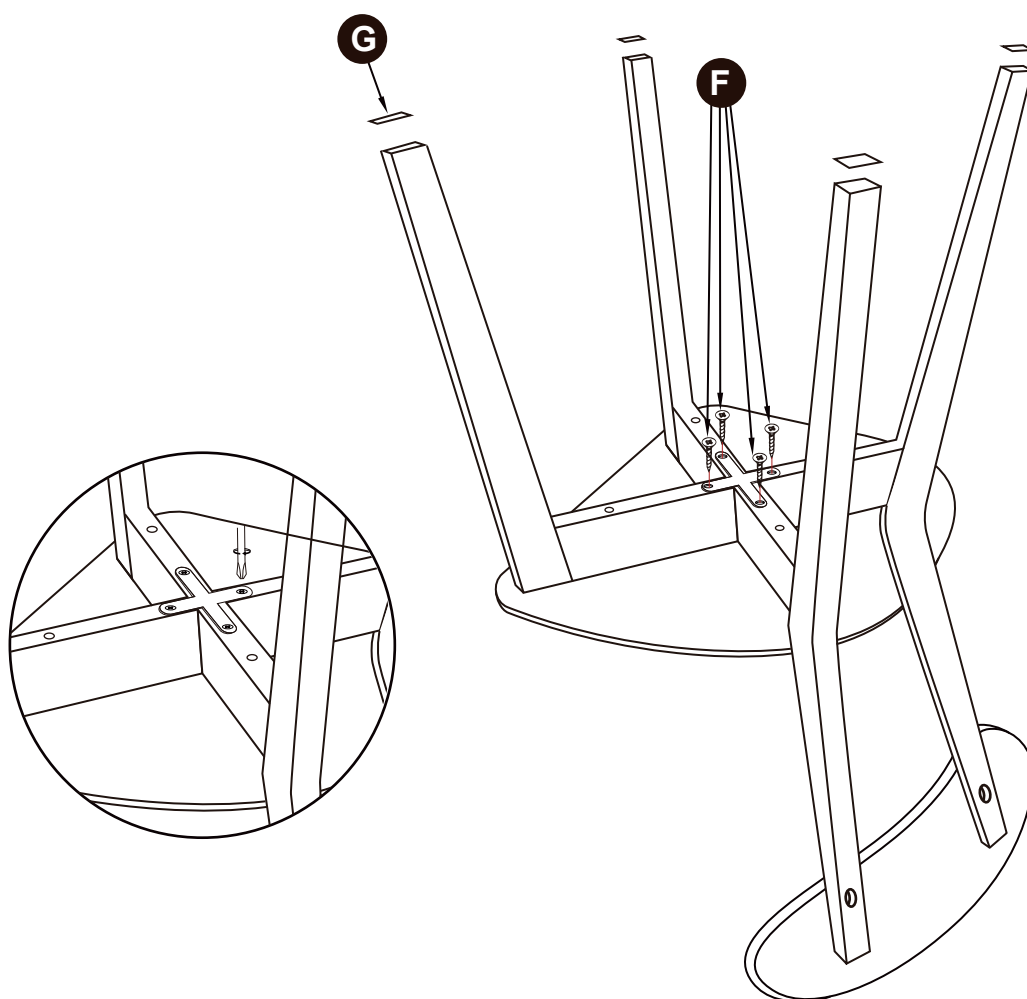

QA for Chair Installation

Q: Why does my chair backrest installation fail?

As shown in the picture below:

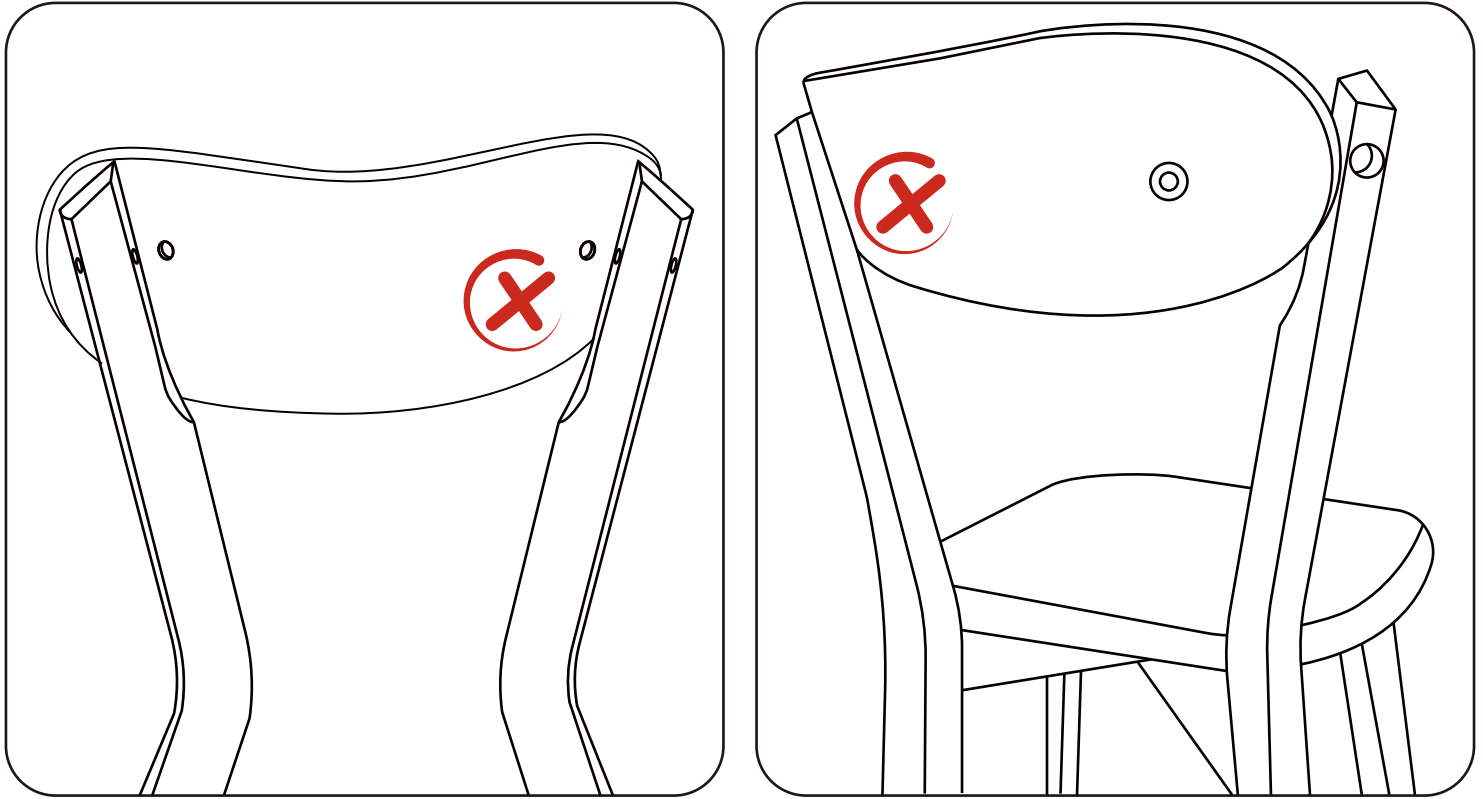

A: If you have difficulty in installing the chair backrest, there may be a problem with the cross direction of the chair legs during the installation process.

You can try the following steps:

1. Disassemble the chair and switch the installation direction of the left and right legs. Cross the left leg so that it is higher than the right leg.
2. Reassemble the chair back after adjusting the legs as described above.

If you still encounter challenges with the installation after swapping the legs, please contact us immediately through Amazon for further assistance. Your satisfaction is our top priority, and we are committed to helping you.

IMPORTANT SAFETY INFORMATION



PLEASE READ WARNINGS

Improper use can cause product damage.

Warning	Do	Don't	Why it's important
Serious damage may happen to the product.	<ul style="list-style-type: none">● Use a dry or slightly damp cloth for cleaning.● Wood expands/contracts with humidity, so check connections every 3 months and tighten screws.	<ul style="list-style-type: none">● Do not harsh chemicals, as alcohol-based cleaners, bleach, acidic or alkaline cleaners, abrasive cleaners and solvents.● Do not expose the chairs to moisture or direct sunlight to prevent warping or fading.	Solid wood products require proper maintenance to ensure they last and accompany you for many years.
Serious injury may occur.	<ul style="list-style-type: none">● When using the dining chairs, please ensure that all 4 legs are on the ground.	<ul style="list-style-type: none">● Do not exceed max load-bearing capacity; overloading may result in structural damage or collapse.● Do not rock the dining chair or lift any of its legs while in use.	To ensure you can use our products safely and enjoyably, please be mindful to avoid any dangerous behaviors.

Get Ready to Assemble

For best results, keep these tips in mind:

- ① Please read the instructions in this guide carefully and complete all steps in order.
- ② Before installing, clear enough space in the area where you plan to place the product.
- ③ If you don't have carpeted flooring, assemble the product on the empty carton to prevent scratches.
- ④ Ask a friend or family member for help, as some steps may be easier with an extra pair of hands.

DO

- ✓ Choose a flat, stable surface for assembly to prevent wobbling.
- ✓ Before installation, verify that all hardware and parts are complete and intact according to the instruction manual and parts list.
- ✓ Before installation, prepare a small ruler to sort the screws by length and consult the instruction manual for the correct installation positions.
- ✓ Use adjustable foot pads for uneven legs stop wobbling.

DON'T

- ✗ Do not skip or reverse the process, strictly follow the steps in the instructions.
- ✗ Do not over-tightening, excessive force can strip screws or crack wood.
- ✗ Do not attempt to use this product before all steps have been completed.
- ✗ Do not install the seat if the chair legs are not level, as it may cause the chair to wobble.



Customer Service

YOU CAN DEPEND ON

If necessary, to quickly free replace damaged / missing parts. Simply have your order ID, photos of outer package, photos of the issue, and label the part numbers on the instruction manual ready when you write an email to us.

Contact Us

Monday to Friday (Except holidays)

We will respond within 24 hours

E-MAIL: service@mordeer.com